



Park Road

Southport, PR9 9JP

£700 Per Month

Flexi-Agent are delighted to present this beautiful, one-bedroom apartment to the lettings market. Situated in the desirable area of Hesketh Park, it is close to a wealth of nearby amenities including Churchtown village and Southport town centre, Hesketh Golf Links and local bus routes.

The property briefly comprises; Entrance hallway, a spacious lounge with plenty of natural light, a fitted kitchen with a brand new fridge freezer and washer/dryer, a double oven and hob, a generous double bedroom with ample fitted wardrobes and a modern shower room. The property also benefits from new carpets throughout and a new fire in the living room.

Externally the property sits in well maintained grounds with ample off road parking to the rear.

Viewings are available on request.

Council Tax Band A.

Deposit £807.69

- One bedroom apartment
- Victorian conversion
- Modern throughout
- First Floor
- Ample storage
- Off road parking
- Well maintained grounds
- Sought after location
- Close proximity to Hesketh Park
- Available in August



Viewing

Please contact our Flexi-Agent Southport Lettings Office on 01704 889455 if you wish to arrange a viewing appointment for this property or require further information.



Floor Plan

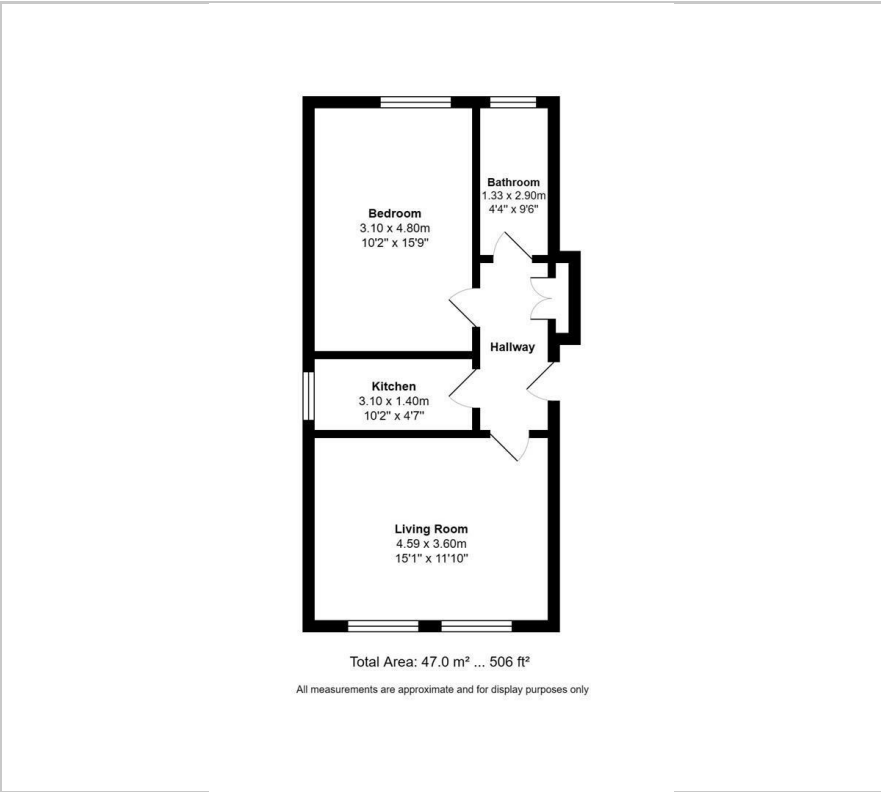

Area Map



Energy Efficiency Graph

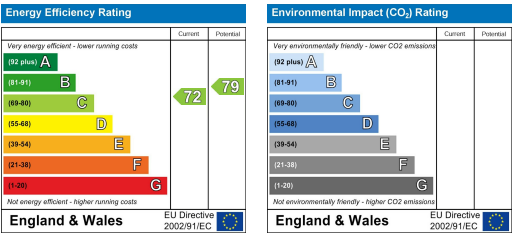

These particulars, whilst believed to be accurate are set out as a general outline only for guidance and do not constitute any part of an offer or contract. Intending purchasers should not rely on them as statements of representation of fact, but must satisfy themselves by inspection or otherwise as to their accuracy. No person in this firms employment has the authority to make or give any representation or warranty in respect of the property.